

REV.	Description			REV.	Description
00	首次发行				
	陈珍珍 2022/2/22				
描述	快速安装指南 T-BAT-Charger 英文版 SOLAX			浙江艾罗网络能源技术股份有限公司 SolaX Power Network Technology (Zhejiang) Co., Ltd.	
料号	320102067600				
单位	mm	页次			

技术要求:

1. 封面封底 157g 铜版纸覆哑膜彩打，内部纸 80g 双胶纸黑白印刷，正反打印；
2. 装订方式：内页大于 60 页时须胶装；
3. 未注尺寸公差按 ± 1.5 mm；
4. 图面、字体印刷清晰、无偏移、无毛边、不起边、油墨不脱落；
5. 黑色字体颜色为 PANTONE BLACK C, 无边框，底色为白色；
6. 符合 ROHS 要求。

描述	快速安装指南 T-BAT-Charger 英文版 SOLAX		设计	陈珍珍 2023/2/22		
			审核	宋 苏 2023/2/22		
材料	双胶纸			核准	施鑫淼 2023/2/22	
料号	320102067600					
单位	mm	页次				
浙江艾罗网络能源技术股份有限公司						

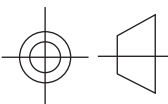
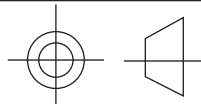

T-BAT-Charger

Installation Manual









www.solaxpower.com

Safety

General Notice

1. Contents may be periodically updated or revised. SolaX reserves the right to make improvements or changes in the product(s) and the program(s) described in this manual without the prior notice.
2. The installation and maintenance can only be performed by qualified personnel who:
 - Are licensed and/or satisfy state and local jurisdiction regulations;
 - Have good knowledge of this manual and other related documents.
3. Before installing the device, carefully read, fully understand and strictly follow the detailed instruction of the user manual and other related regulations. SolaX shall not be liable for any consequences caused by the violation of the storage, transportation, installation, and operation regulations specified in this document and the user manual.
4. Use insulated tools when installing the device. Individual protective tools must be worn during installation, electrical connection and maintenance.
5. Please visit the website www.solaxpower.com of SolaX for more information.

Descriptions of Labels

	The battery module may explode		Caution, risk of electric shock
	Caution, risk of danger		Safety glasses must be worn
	Read the enclosed documentations		Keep the battery system away from children
	Keep the battery system away from open flames or ignition systems		Don't tip over the Charger when it is working.

Note: The table is only used for the description of symbols which may be used on the battery. Please be subject to the actual symbols on the device.

General Safety Precautions

1. Do not install the Charger in places where flammable and combustible materials are stored, and in which an explosive atmosphere is present;
2. The wiring of Charger shall be carried out by qualified personnel;
3. The Charger must be serviced by qualified personal;

Battery Handling Guide

Do's

- DO wear complete safety goggles when charging;
- DO keep the Charger away from flammables materials, heat sources, and water sources;
- DO keep the Charger out of reach of children and animals;
- DO keep the Charger clean and dry all the time, or there may lie an electrocution hazard if the device gets wet;
- DO practice proper storage by keeping the Charger in a clean environment, free of dust, dirt and debris;
- DO store the Charger in a cool and dry place;
- DO seal the outer cable connection hole to prevent ingress of foreign objects;
- DO confirm that the wiring of the Charger must be correct;
- DO remove the Charger form the battery, make sure that the system is turned off.
- DO connect the Charger according to the local standards and regulations.

Don'ts

- DON'T expose the Charger to an open flame, or the temperature in excess of 140°F/60°C;
- DON'T store or install the Charger in direct sunlight;
- DON'T install or operate the Charger in places where there is excessive moisture or liquids;
- DON'T place the Charger in a high-voltage environment;
- DON'T disconnect, disassemble or repair the device by unqualified personnel. Only a qualified personnel is allowed to handle, install and repair the device;
- DON'T damage the device by dropping, deforming, impacting, cutting or penetrating with a sharp object. Otherwise, it may cause a fire;
- DON'T touch the Charger when it gets hot. It may cause burns;
- DON'T step on the packaging or the device may be damaged;
- DON'T drop a tool on top of the Charger;
- DON'T charge or discharge a damaged Charger;
- DON'T dispose of the Charger in a fire. It may cause rupture, resulting in personal injury or property damage.
- DON'T tip over the Charger when it is working.

Response to Emergency Situations

In case the battery module leaks electrolyte or any other chemical materials, or gas may be generated due to the leakage of battery module, be sure to avoid contact with the discharge at all times. In case of accidentally coming into contact with them, please do as follows:

- In case of inhalation: Leave the contaminated area immediately, and seek medical attention at once;
- In case of contact with eyes: Rinse eyes with running water for 15 minutes, and seek medical attention;
- In case of contact with skin: Wash the contacted area thoroughly with soap, and seek medical attention;
- In case of ingestion: Induce vomiting, and seek medical attention.

If a fire breaks out where the Charger is connected, please do as follows:

- In case the Charger is charging when the fire breaks out, provide it is safe to do so, turn off the Charger, and shut off the power charge of the battery system;
- In case the device is not on fire yet, use a Class ABC fire extinguisher or a carbon dioxide extinguisher to extinguish the fire;
- If the Charger catches fire, do not try to put out the fire, and evacuate immediately.

Effective ways to deal with accidents

- In case of the damaged Charger, place it into a segregated place, and call the local fire department at the place where the user lives or qualified personnel.
- If any part of the Charger, or wiring is submerged, DO stay out of the water and DON'T touch anything; If the Charger gets wet, DON'T touch it.
- If the Charger is damaged, DON'T use it. Otherwise, it may result in both personal injury and property damage.
- DON'T use the submerged Charger again, and contact the qualified personnel for assistance.
- DO contact SolaX immediately for assistance if the user suspects that the Charger is damaged.

Packing List

T-BAT-Charger

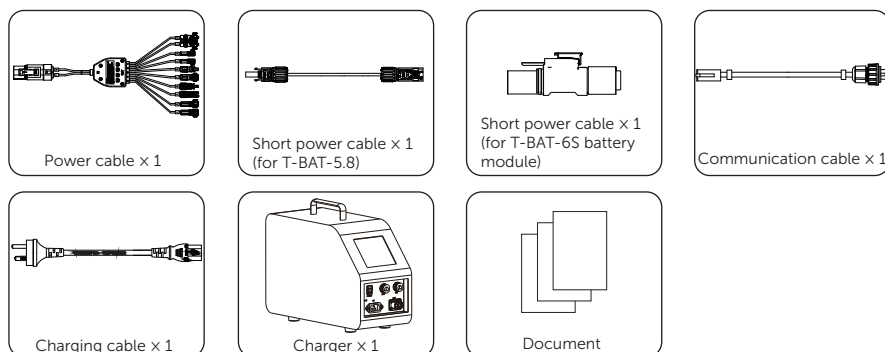

Installation Site

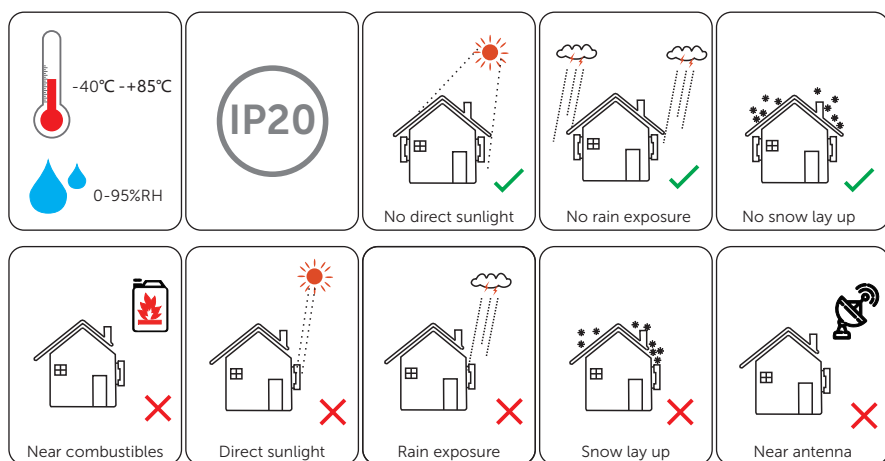

Tools



Technical Data

Electrical Characteristics

Max. AC Input Apparent Power	2200 VA
Max. AC Input Current	10 A
Nominal AC Voltage (AC Voltage Range)	220 V (180~264 V)
Nominal Grid Frequency	47~63 Hz
Efficiency	90%
Surge Current (230 V Cold Start)	60 A
Output Voltage Range	40~150 V
Max. Charging Current	0~12 A
Voltage Accuracy	1.0%
Max. Number of Batteries Supported	2 PCS

Operating Conditions

Enclosure Protection	IP20
Operating Temperature Range	0°C to 50°C
Relative Humidity	20%RH to 90%RH (Non-condensing)
Storage Temperature	-40°C to 85°C
Storage Humidity	10%RH to 95%RH (Non-condensing)
Cooling Type	Smart Cooling

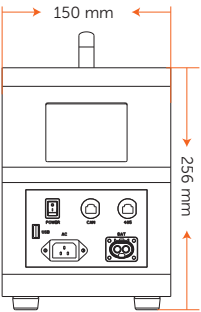

	Charger
Length	402 mm
Width	150 mm
Height	256 mm
Weight	7.1 kg

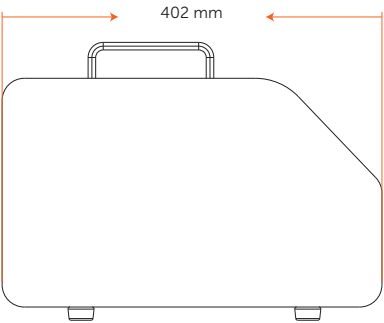

Machine Introduction

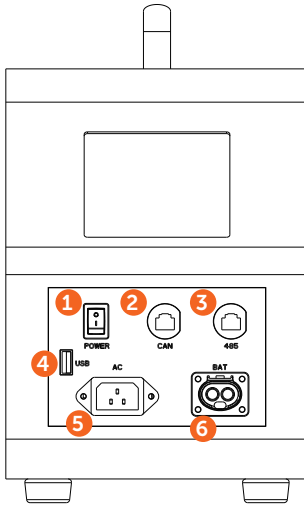

1	Power switch: To turn on/off the device
2	CAN port: To connect communication cable
3	485 port: To connect communication cable (for battery module of T-BAT-5.8 V1/V2 only)
4	USB port: To insert USB flash disk to upgrade
5	AC port: To connect charging cable
6	BAT port: To connect power cable

Power Cable Introduction

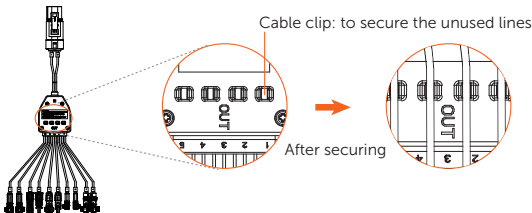
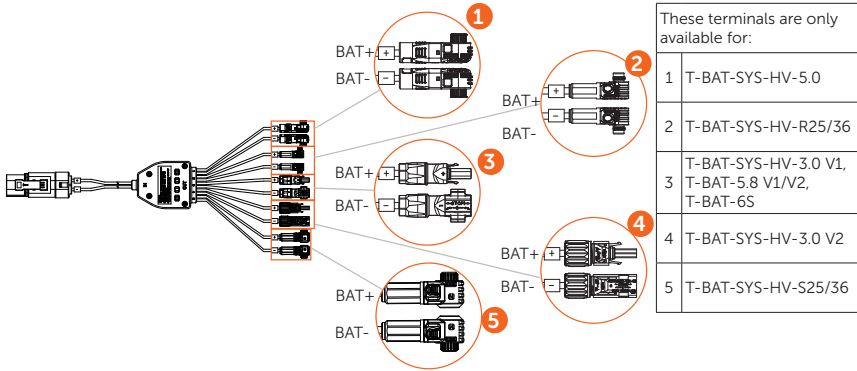

There are 4 clips on one side of the power cable, with a total of 8 clips.

Wiring Diagram between Charger and Battery

T-BAT-SYS-HV-3.0 V1

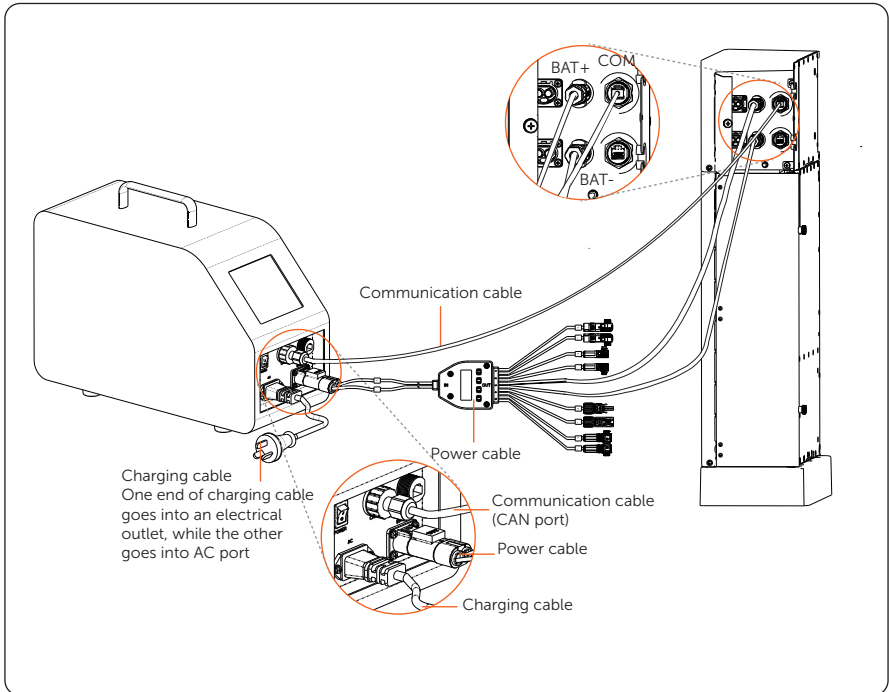

*Note:

1. The remaining connectors on the power cable must be snapped into the cable clips. There are 4 clips on one side of the power cable, with a total of 8 clips.
2. Connectors must be protected from short-circuiting, immersion in water and moisture. Users should avoid coming into contact with the conductor materials.
3. Only one battery can be charged at once with the Charger.

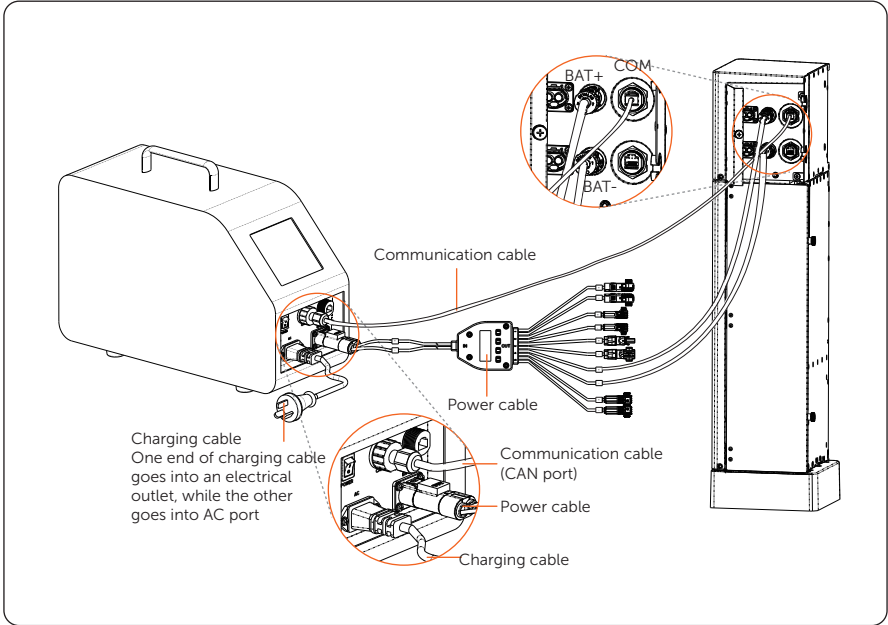

*Note:

1. The remaining connectors on the power cable must be snapped into the cable clips. There are 4 clips on one side of the power cable, with a total of 8 clips.
2. Connectors must be protected from short-circuiting, immersion in water and moisture. Users should avoid coming into contact with the conductor materials.
3. Only one battery can be charged at once with the Charger.

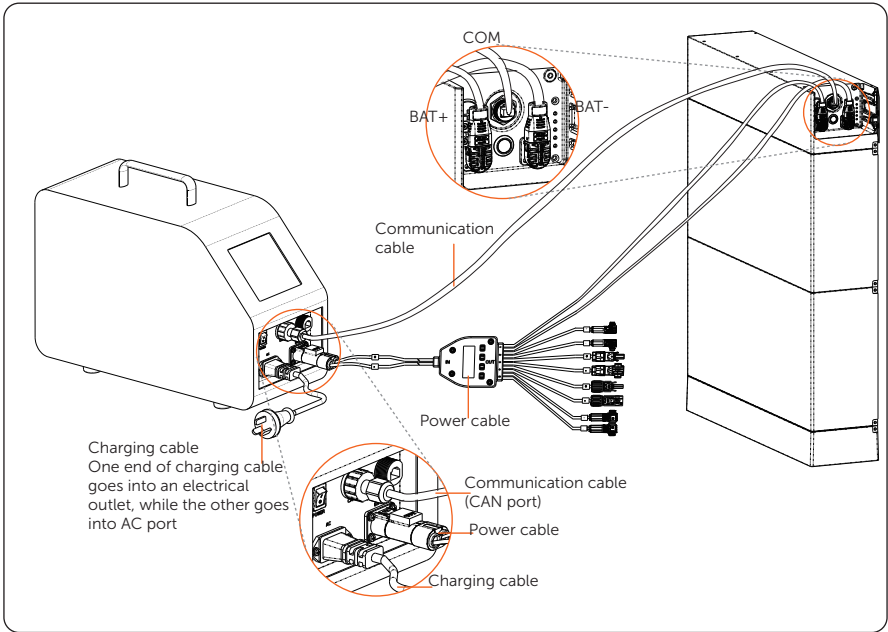

*Note:

1. The remaining connectors on the power cable must be snapped into the cable clips. There are 4 clips on one side of the power cable, with a total of 8 clips.
2. Connectors must be protected from short-circuiting, immersion in water and moisture. Users should avoid coming into contact with the conductor materials.
3. Up to two batteries can be charged at once with the Charger.

T-BAT-5.8 V1/V2 (with BMS)

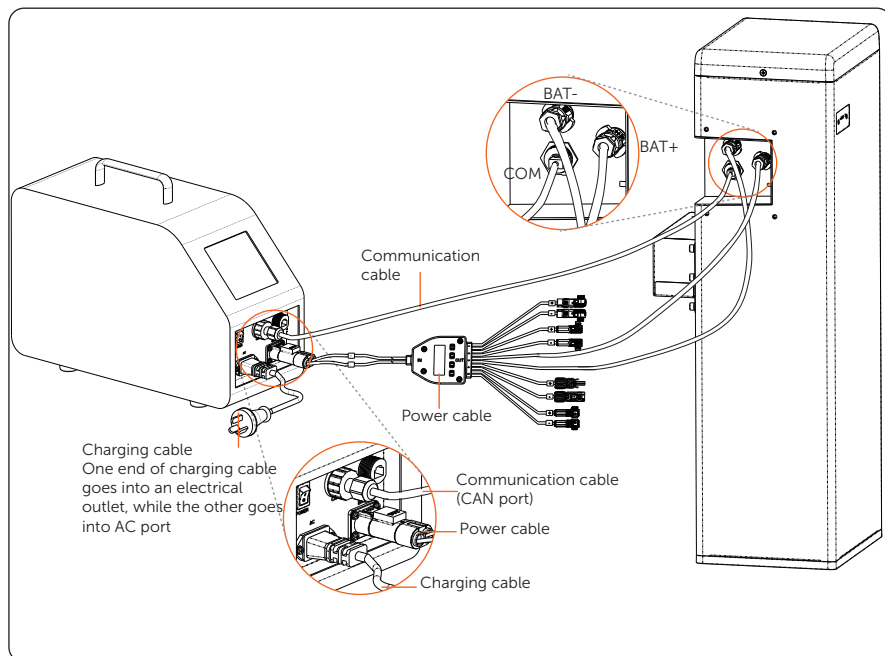

*Note:

1. The remaining connectors on the power cable must be snapped into the cable clips. There are 4 clips on one side of the power cable, with a total of 8 clips.
2. Connectors must be protected from short-circuiting, immersion in water and moisture. Users should avoid coming into contact with the conductor materials.
3. Only one battery (T-BAT-5.8 V1/V2 with BMS) can be charged at once with the Charger.

T-BAT-5.8 V1/V2 (without BMS)

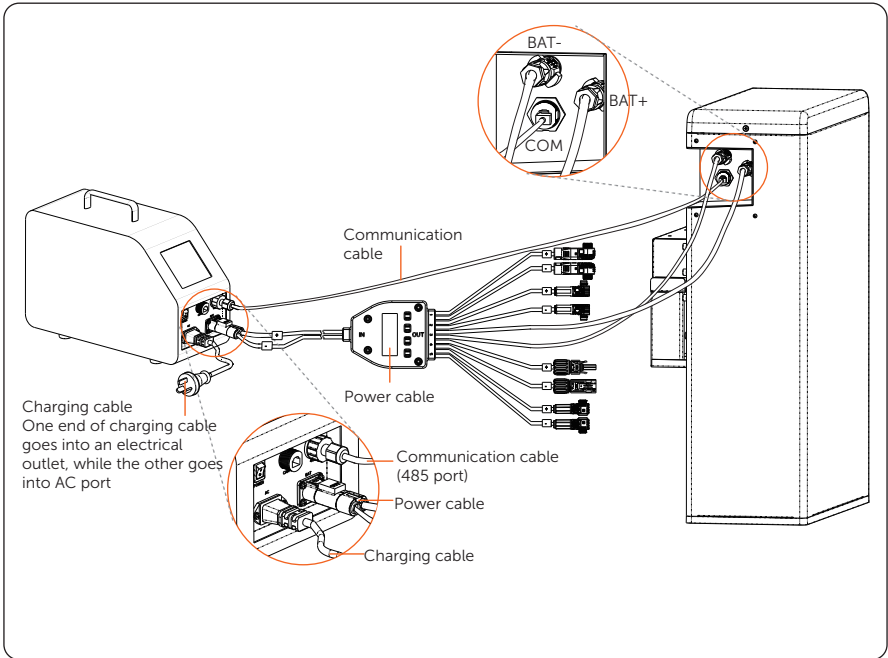

*Note:

1. The remaining connectors on the power cable must be snapped into the cable clips. There are 4 clips on one side of the power cable, with a total of 8 clips.
2. Connectors must be protected from short-circuiting, immersion in water and moisture. Users should avoid coming into contact with the conductor materials.
3. Only one battery (T-BAT-5.8 V1/V2 without BMS) can be charged at once with the Charger.

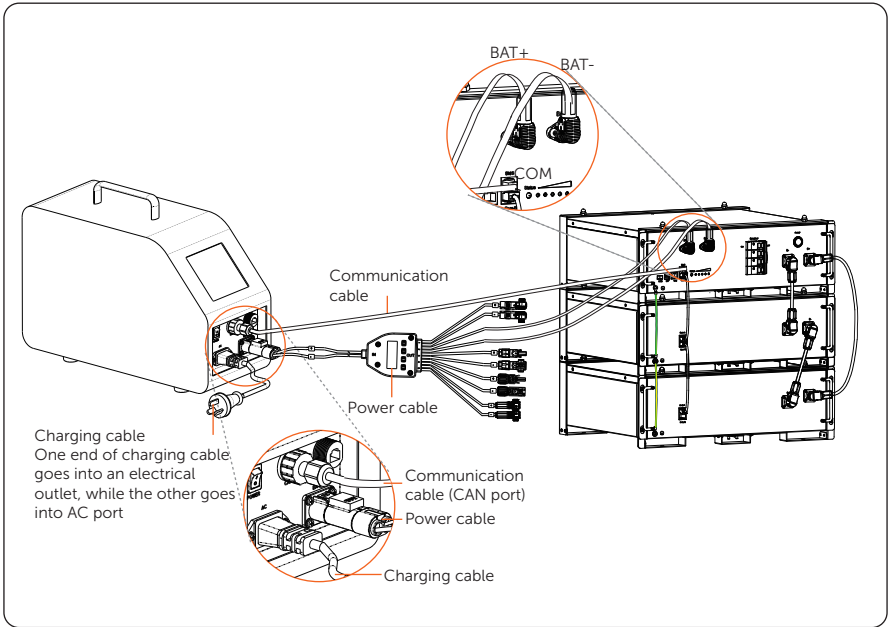

*Note:

1. The remaining connectors on the power cable must be snapped into the cable clips. There are 4 clips on one side of the power cable, with a total of 8 clips.
2. Connectors must be protected from short-circuiting, immersion in water and moisture. Users should avoid coming into contact with the conductor materials.
3. Up to two batteries can be charged at once with the Charger.

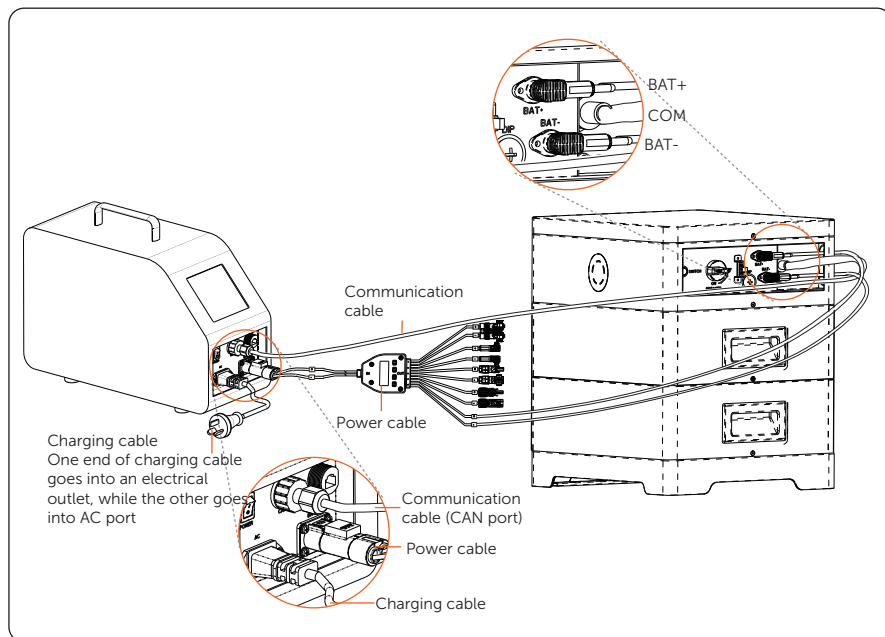

***Note:**

1. The remaining connectors on the power cable must be snapped into the cable clips.
There are 4 clips on one side of the power cable, with a total of 8 clips.
2. Connectors must be protected from short-circuiting, immersion in water and moisture.
Users should avoid coming into contact with the conductor materials.
3. Up to two batteries can be charged at once with the Charger.

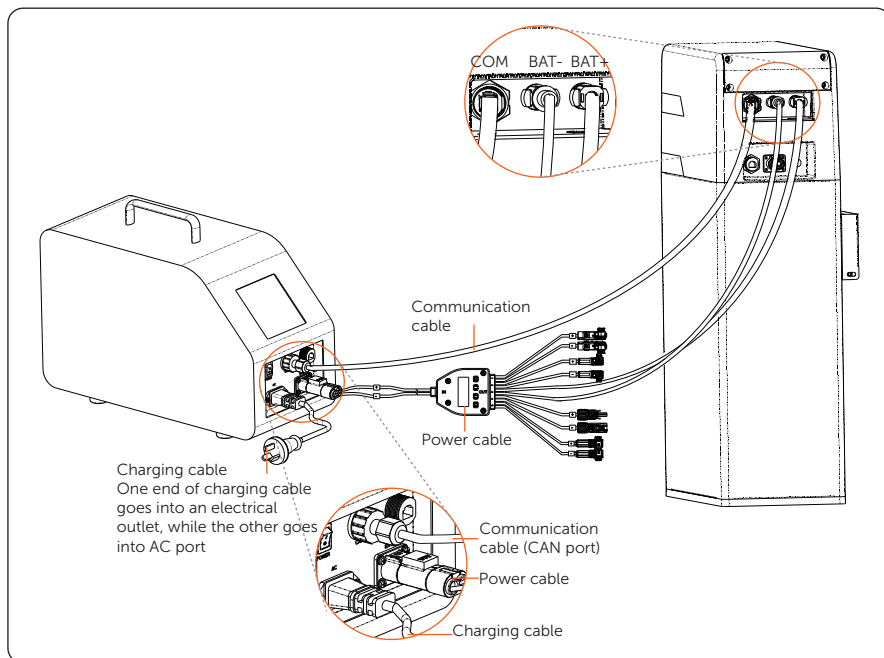

***Note:**

1. The remaining connectors on the power cable must be snapped into the cable clips. There are 4 clips on one side of the power cable, with a total of 8 clips.
2. Connectors must be protected from short-circuiting, immersion in water and moisture. Users should avoid coming into contact with the conductor materials.
3. Only one battery can be charged at once with the Charger.

Power on the System

After finishing the wiring, toggle the "POWER" switch to start the Charger.

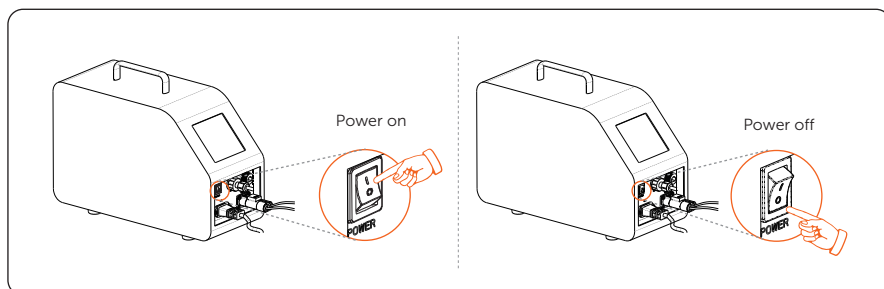

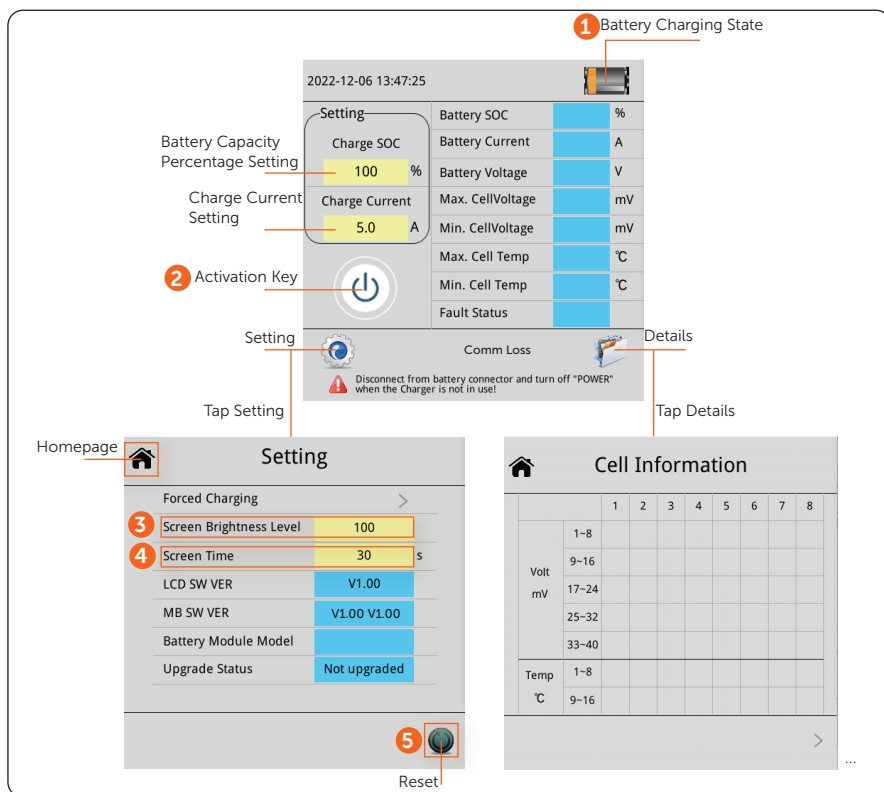

*Note:

1. Battery Charging State: If the icon is green and the green light cycles, the device is charging. Otherwise, it is not charging.
2. Activation Key: If the Key snaps and the colour shows white, the device will stop charging; if the Key is pressed and the colour shows yellow, the device will start charging.
3. Screen Brightness Level: The screen brightness can be manually adjusted by the user, with a level of 0 to 100.
4. Screen Time: The screen time also can be adjusted by the user, with a time range of 30 to 240 seconds.

Forced Charging

The Charger supports the function of "forced charging," and the function requires a password to start.

1. Tap the "Setting";
2. Tap the "Forced Charging";
3. Enter a password;

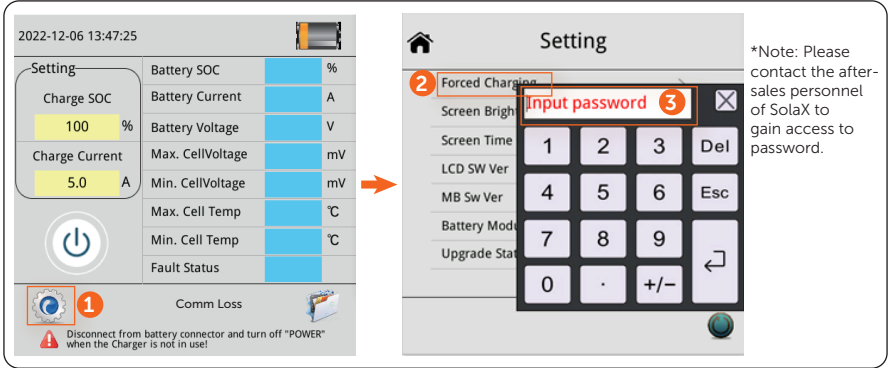

4. Tap to set a time limit for 5 minutes to 15 minutes before charging. The default time limit is 5 minutes;

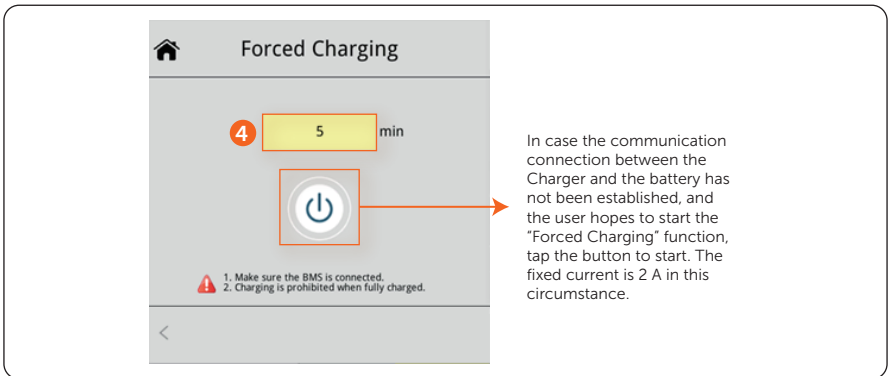

*Note: The "Forced Charging" must be disabled in case of the following circumstances:

1. The ambient temperature is below 0°C or over 55°C;
2. 100% SOC

In the following circumstances, the "Forced Charging" will be stopped:

- Time's up;
- Battery fault;
- Communication between the Charger and battery is established;
- Tap the button.

Upgrade

The Charger supports the function "Upgrade". If a user wants to upgrade the device,

1. Please contact the after-sales personnel of the company to obtain the Upgrade File;
2. Copy such File to a USB Flash Disk (USB 2.0 or later is required);
3. Insert the USB Flash Disk, tap "Yes" to jump to "Reset" page, and then you're off to the races.

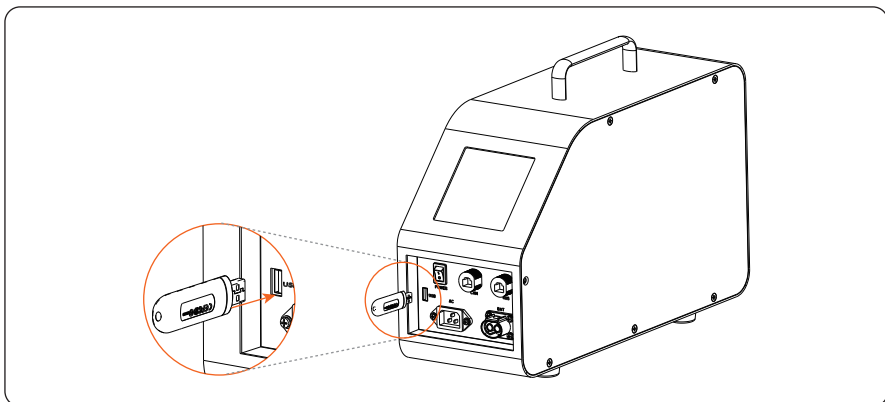

*Note: The above-mentioned USB flash disk will not be provided by SolaX.

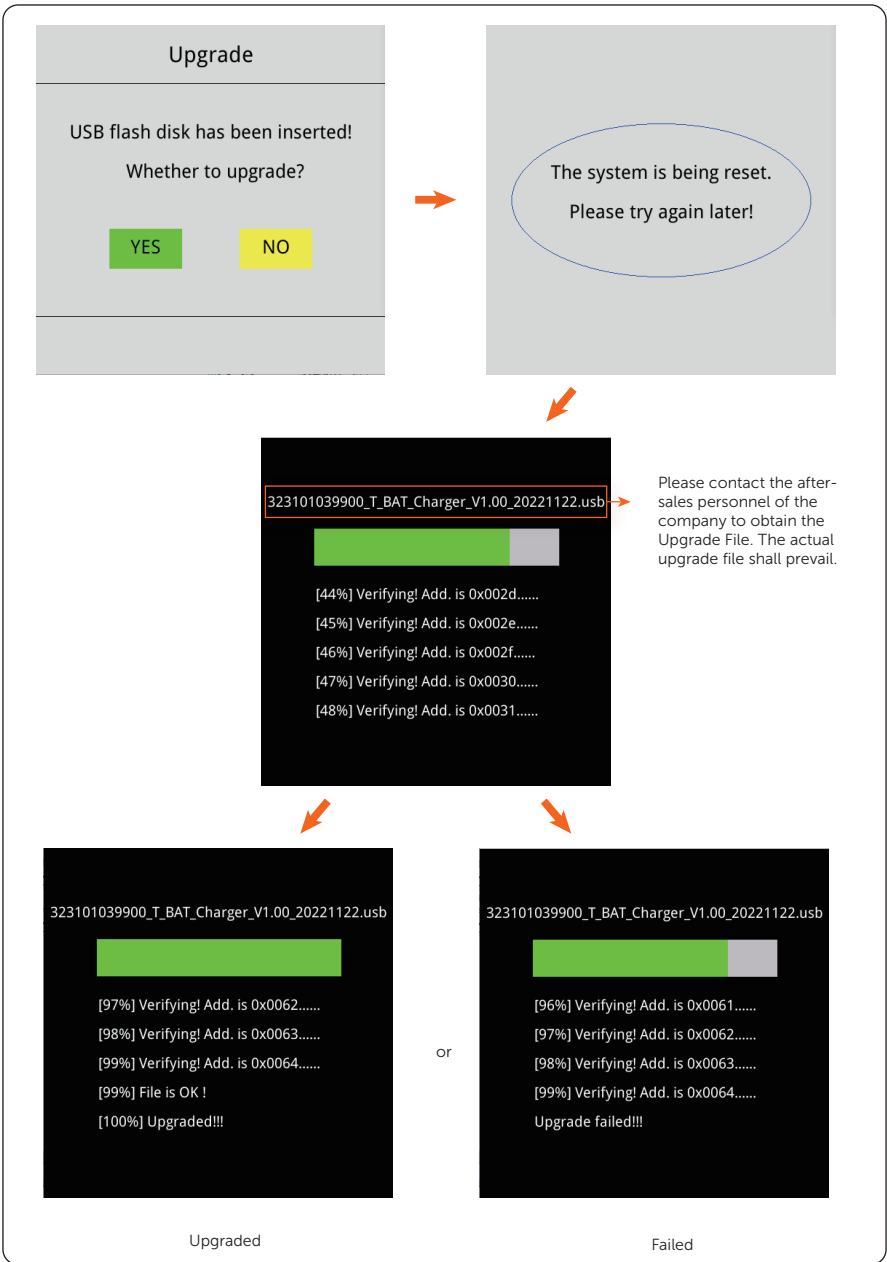

*Note: Please DON'T shut down the device, DON'T remove the USB flash disk, and DO keep it plugged in all the time while upgrading, or the upgrade will fail.

Contact Information



UNITED KINGDOM

📍 Unit 10, Eastboro Fields, Hemdale Business Park, Nuneaton, CV11 6GL
☎ +44 (0) 2476 586 998
✉ info@solaxuk.co.uk



AUSTRALIA

📍 12-18 Lascelles St, Springvale VIC 3171
☎ +61 1300 476 529
✉ support@solaxpower.com.au



TURKEY

📍 Esenşehir Mah. Hale Sk. No:6/1 Ümraniye / İSTANBUL
☎ +90 (216) 622 58 00 (pbx)
✉ service.eu@solaxpower.com



GERMANY

📍 Eisenstraße 3, 65428 Rüsselsheim am Main, Germany
☎ +49 (0) 6142 4091 664
✉ service.eu@solaxpower.com



USA

📍 3780 Kilroy Airport Way, Suite 200, Long Beach, CA, US 90806
✉ info@solaxpower.com



NETHERLANDS

📍 Twekkeler-Es 15 7547 ST Enschede
☎ +31 (0) 8527 37932
✉ service.eu@solaxpower.com
✉ service.bnl@solaxpower.com



POLAND

📍 WARSAW AL. JANA P. II 27. POST
☎ +48662430292
✉ Thomas.W@solaxpower.com
✉ service.pl@solaxpower.com



SPAIN

☎ +34683197401
✉ tecnico@solaxpower.com



ITALY

☎ +393518157758
✉ tecn.it@solaxpower.com



BRAZIL

☎ +55 (34) 9667 0319
✉ info@solaxpower.com

Warranty Registration Form



For Customer (Compulsory)

Name _____ Country _____
Phone Number _____ Email _____
Address _____
State _____ Zip Code _____
Product Serial Number _____
Date of Commissioning _____
Installation Company Name _____
Installer Name _____ Electrician License No. _____

For Installer

Module (If Any)

Module Brand _____
Module Size(W) _____
Number of String _____ Number of Panel Per String _____

Battery (If Any)

Battery Type _____
Brand _____
Number of Battery Attached _____
Date of Delivery _____ Signature _____

Please visit our warranty website: <https://www.solaxcloud.com/#/warranty> or use your mobile phone to scan the QR code to complete the online warranty registration.



For more detailed warranty terms, please visit SolaX official website: www.solaxpower.com to check it.





SolaX Power Network Technology (Zhejiang) Co., Ltd.

Add.: No. 288, Shizhu Road, Tonglu Economic Development Zone,
Tonglu City, Zhejiang Province, 310000 P. R. CHINA

Tel.: +86 (0) 571 5626 0011

E-mail: info@solaxpower.com / service@solaxpower.com

