

## K 4245 3D

for lightweight PVCu doors for flexible fixing



### Product features

- for overlap thicknesses 21-25 mm
- door part for flexible fixing
- 3D adjustment (side  $\pm 5,0$  mm, height  $+ 5,0/- 1,0$  mm, compression  $\pm 2,0$  mm)
- with integral security pin
- maintenance-free slide bearings

### Technical data

Property	Value
Load capacity	80,0 kg
Knuckle length	100,0 mm
Knuckle Diameter	21,0 mm
Pin diameter	8,0 mm

### Notes

The load capacity mentioned above refers to the use of 2 hinges per door leaf (1 x 2 m), for detailed information please look at the chapter [technical information](#).

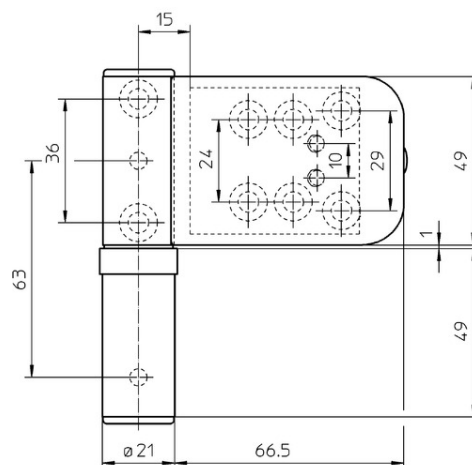

front view

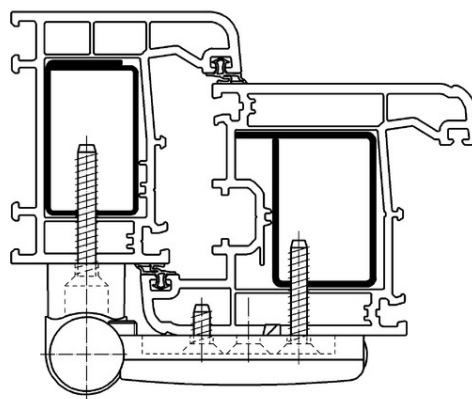

cross section

**SIKU - K 4245 3D**

---

**Installation tools**

---

Drilling jig SIKU Series K4  
simultaneous fixing Type 4

**Item versions**

---

Finish	RAL 9016 Traffic White (SW 070)
VPE	pack of 3
DIN	DIN right and left hand
Article number	5 190860 0 07003
EAN	4015471090333