

K 4245 3D

for lightweight PVCu doors for flexible fixing



Product features

- for overlap thicknesses 21-25 mm
- door part for flexible fixing
- 3D adjustment (side $\pm 5,0$ mm, height $+ 5,0/- 1,0$ mm, compression $\pm 2,0$ mm)
- with integral security pin
- maintenance-free slide bearings

Technical data

Property	Value
Load capacity	80,0 kg
Knuckle length	100,0 mm
Knuckle Diameter	21,0 mm
Pin diameter	8,0 mm

Notes

The load capacity mentioned above refers to the use of 2 hinges per door leaf (1 x 2 m), for detailed information please look at the chapter [technical information](#).

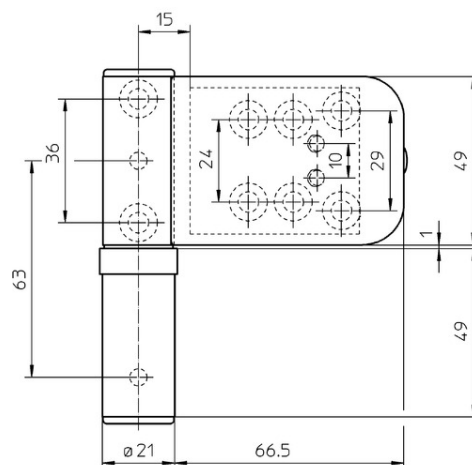

front view

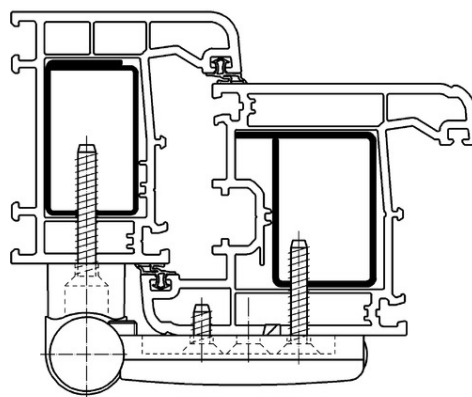

cross section

SIKU - K 4245 3D**Installation tools**

Drilling jig SIKU Series K4
simultaneous fixing Type 4

Item versions

Finish	RAL 9016 Traffic White (SW 070)
VPE	pack of 3
DIN	DIN right and left hand
Article number	5 190860 0 07003
EAN	4015471090333