

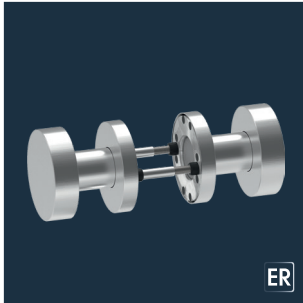

Knob/knob handle sets



K-135 knob/knob handle set



K-135 knob on OKL round rose as an easy assembly knob/knob handle set, screwed through M5 with a high-strength plug-in/screw connection. Complete with cover rose (R 0.5mm) and pre-assembled sleeve nuts (M5x30mm).

	Model	Door thickness	 
ER	Knob-knob set	38-45	5030063570
ER	Knob-knob set	44-66	5030063571

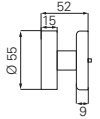

K-130 knob/knob handle set



K-130 knob on OGL Click round rose as an easy assembly knob/knob handle set, screwed through M5 with a high-strength plug-in/screw connection. Complete with cover rose (R 1.5mm) and pre-assembled sleeve nuts (M5x30mm).

	Model	Door thickness	 
ER	Knob-knob set	38-45	5030063572
ER	Knob-knob set	44-66	5030063573

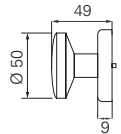

OKL Magis knobs



K-116 round rose



K-116 knob on OKL round rose.
Complete with cover rose and pre-assembled sleeve nuts (M5x30mm) for screwing through, along with M12 screw thread for barrel handle/knob spindles.
Be sure to order the accompanying fixing material if necessary.

	Model	
ER	Left knob, fixed	5030020134
ER	Right knob, fixed	5030020132

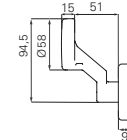

K-117 round rose



K-117 knob on OKL round rose.
Complete with cover rose and pre-assembled sleeve nuts (M5x30mm) for screwing through, along with M12 screw thread for barrel handle/knob spindles.
Be sure to order the accompanying fixing material if necessary.

	Model	
ER	Left knob, fixed	5030058883
ER	Right knob, fixed	5030058884

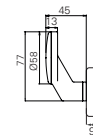

K-135 round rose



K-135 knob on OKL round rose.
Complete with cover rose and pre-assembled sleeve nuts (M5x30mm) for screwing through, along with M12 screw thread for barrel handle/knob spindles.
Be sure to order the accompanying fixing material if necessary.

	Model	
ER	Knob, fixed	5030019812

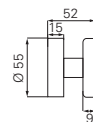

K-160 round rose



K-160 knob on OKL round rose.
Complete with cover rose and pre-assembled sleeve nuts (M5x30mm) for screwing through, along with M12 screw thread for barrel handle/knob spindles.
Be sure to order the accompanying fixing material if necessary.

	Model	
ER	Left knob, fixed	5030037851
ER	Right knob, fixed	5030037310

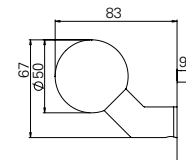

K-165 round rose



K-165 knob on OKL round rose.
Complete with cover rose and pre-assembled sleeve nuts (M5x30mm) for screwing through, along with M12 screw thread for barrel handle/knob spindles.
Be sure to order the accompanying fixing material if necessary.

	Model	
ER	Knob, fixed	5030023068

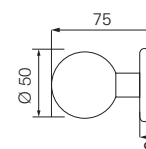

OGL round rose knobs



K-117 round rose



K-117 knob on OGL round rose.

Complete with cover rose and pre-assembled sleeve nuts (M5x30mm) for screwing through, along with M12/M8 screw thread for DIN L/R fixing.

Be sure to order the accompanying fixing material if necessary.

	Model	
ER	Can be used for DIN L/R	5030058885
AI	Can be used for DIN L/R	5030058886

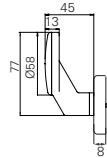

K-130 round rose



K-130 knob on OGL Click round rose.

Complete with cover rose and pre-assembled sleeve nuts (M5x30mm) for screwing through, along with M12 screw thread for barrel handle/knob spindles.

Be sure to order the accompanying fixing material if necessary.

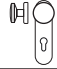
		
ER	5030012313	5030012429
AI	5030012409	5030012378

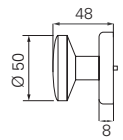

K-135 round rose



K-135 knob on OGL round rose.

Complete with cover rose and pre-assembled sleeve nuts (M5x40mm) for screwing through, along with M12 screw thread for barrel handle/knob spindles.

Be sure to order the accompanying fixing material if necessary.

	Model	
ER	Knob, fixed	5030027912

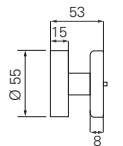



K-165 round rose



K-165 knob on OGL round rose.

Complete with cover rose and pre-assembled sleeve nuts (M5x30mm) for screwing through, along with M12 screw thread for barrel handle/knob spindles.

Be sure to order the accompanying fixing material if necessary.

		
ER	5030063574	5030063566

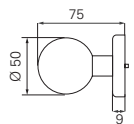

OGL Click round rose knobs



K-117 round rose



K-117 knob on OGL Click round rose.
 Complete with cover rose and pre-assembled sleeve nuts (M5x30mm) for screwing through, along with M12/M8 screw thread for DIN L/R fixing.
 Be sure to order the accompanying fixing material or switch barrel handle/knob spindle if necessary.

	Model	
ER	Can be used for DIN L/R	5030063295
AI	Can be used for DIN L/R	5030063296

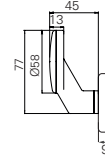

K-130 round rose



K-130 knob on OGL Click round rose.
 Complete with cover rose and pre-assembled sleeve nuts (M5x30mm) for screwing through, along with M12 screw thread for barrel handle/knob spindles.
 Be sure to order the accompanying fixing material if necessary.

	
ER	5030048652
AI	5030050389

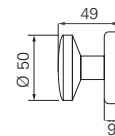

K-160 round rose



K-160 knob on OGL Click round rose.
 Complete with cover rose and pre-assembled sleeve nuts (M5x30mm) for screwing through, along with M12/M8 screw thread for DIN L/R fixing.
 Be sure to order the accompanying fixing material or switch barrel handle/knob spindle if necessary.

	Model	
ER	Knob, fixed	5030062211

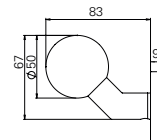

K-165 round rose



K-165 knob on OGL Click round rose.
 Complete with cover rose and pre-assembled sleeve nuts (M5x30mm) for screwing through, along with M12/M8 screw thread for DIN L/R fixing.
 Be sure to order the accompanying fixing material or switch barrel handle/knob spindle if necessary.

	
ER	5030048656

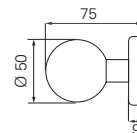

OGL oval rose knobs



K-110 oval rose

K-110 knob on OGL oval rose.
Complete with cover rose and M8 screw thread for handle/knob spindles for screw attachment on one side.

Be sure to order the accompanying fixing material if necessary.

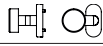
		
ER	5030009418	

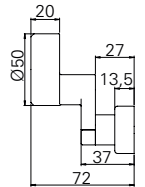

K-116 oval rose

K-116 knob on OGL oval rose for one-sided fixing.

Complete with base and cover rose. Knob is screwed tight.

Not suitable for fixing with knob/lever or barrel handle/knob spindles.

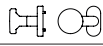
		
ER	5030009431	

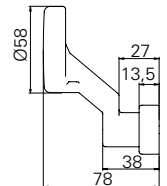

K-117 oval rose

K-117 knob on OGL oval rose with positioning studs.

Complete with cover rose and M12 screw thread for barrel handle/knob spindles for screw attachment on one side incl. M5x22 countersunk fixing screw.

		
ER	5030058887	
AI	5030058888	

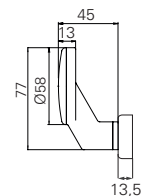

K-120 oval rose

K-120 knob on OGL oval rose.

Complete with cover rose and M8 screw thread for handle/knob spindles for screw attachment on one side.

Be sure to order the accompanying fixing material if necessary.

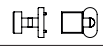
		
ER	5030009620	

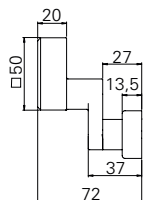

K-160 oval rose

K-160 knob on OGL oval rose.

Complete with cover rose and M12 screw thread for barrel handle/knob spindles for screw attachment on one side.

Square 9 mm for the 'fixed swivel-mounted' model.

Be sure to order the accompanying fixing material if necessary.

ER	Fixed	5030035387	Fixed swivel-mounted	5030042563
AI	Fixed	5030035388	Fixed swivel-mounted	5030047898

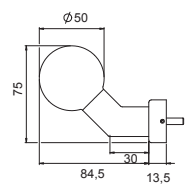

OGL oval rose knobs



K-165 oval rose

K-165 knob on OGL oval rose.
 Complete with cover rose and M12 screw thread for barrel handle/knob spindles for screw attachment on one side.
 Square 9 mm for the 'fixed swivel-mounted' model.
 Be sure to order the accompanying fixing material if necessary.

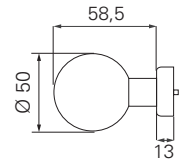

ER	Fixed	5030009460	Fixed swivel-mounted	5030040871
-----------	-------	------------	----------------------	------------

Product information and use of ECO fitting technology

§ 1 Product information and intended use

1. The fitting systems made by ECO are assistive systems that can be used to help with opening and closing motions and/or locking processes for doors, glass doors and window elements.
2. The fixing elements supplied with these products must be used and installed according to the mounting instructions/specifications.

§ 2 Improper use of the products

Improper use of fitting systems for doors and windows (i.e. not using the product as intended) includes the following situations in particular:

- Installation or mounting of foreign objects and/or objects not intended for this purpose into the fitting system;
- Using auxiliary tools to operate the system;
- The fittings are used as a replacement for a missing wall buffer;
- Fittings are misused as a suspension device for heavy loads;
- Fittings are used long-term in combination with panic locks instead of only in emergencies, against the recommendation of the lock and fitting industry;
- Surface of the fitting systems damaged by the use of sharp or hard objects;
- The usage of fixing elements made by third-party manufacturers.

Sooner or later, these errors will cause damage, and the products will no longer have the characteristics defined by the manufacturer.

§ 3 Product performance

1. Product performance is only partially governed by standards. Many aspects of product performance have been developed based on years of experience and should be considered common knowledge in the construction hardware industry. Correspondingly, the contents of these standards and these empirical values should also be applied to fittings that are not expressly regulated.
2. Specifically, the following standards apply:
 - EN 1906: General benchmarks for door fittings and accessories;
 - DIN 18273: Special rules for fire and smoke control doors;
 - DIN 18257: Minimum security requirements for security fittings.
3. The fitting system must be replaced if, despite maintenance and servicing, it can no longer be ensured that it will function properly, and/or it may pose a risk of injury.
4. Furthermore, the products are continuously being improved, and manufacturing is subject to quality assurance. The right to make technical changes is reserved.

§ 4 Product maintenance

1. The user must ensure that the fitting systems and fixing elements are installed in a proper functional manner.
2. Depending on the material and where they are used, the products will face a certain degree of natural wear and tear. Consequently, all moving parts must undergo maintenance at least once per year; i.e. the proper fit, stability of the screw connections, etc. must be checked on a regular basis. Only water, gentle cleaning agents and other cleaning agents that do not contain corrosive ingredients should be used for cleaning the fitting systems.
3. Manufacturing primarily uses the materials nylon, aluminium, stainless steel and brass. Please note that each of these different materials has different maintenance and servicing requirements.

§ 5 Duty to inform and instruct

1. The following documents are available to provide information and instruction:
 - Catalogues and brochures;
 - Tender documents;
 - Procurement information;
 - Bid documents;
 - Installation and operating instructions;
 - DIN standards.
2. In order to ensure that the fitting systems function properly:
 - Architects, planners and any other people involved in the process are required to request all the necessary product information from us and to comply with said information,
 - Specialised retailers are required to observe the product information and notes in the price lists and catalogues and, in particular, to request all required instructions from us and to pass them on to the processors,
 - The processors are required to obtain all product information and to comply with it, and, in particular, to request the operating and maintenance instructions from us and pass them on to the customers and users.

Overall, all parties involved must ensure that the fitting systems are properly assembled and installed and that each end user receives proper instructions and explanations.



ECO recommends:

- For lever handle sets without a return spring, we recommend using locks that comply with **DIN 18251**- class 3 or higher.
- In order to minimise the clearance between the lever handle set and the lock, we recommend locks that comply with **DIN 18251** with a clamping nut.
- When ECO fittings are properly installed and used, the paint should withstand daily use. Excessive contact with hard or sharp objects (such as key rings, rings, etc.) can scratch the surface. This does not impact the functionality, however.

ECO Schulte GmbH & Co. KG

Iserlohner Landstraße 89

D-58706 Menden

Telephone +49 2373 9276 - 0

Telefax +49 2373 9276 - 40

info@eco-schulte.de

www.eco-schulte.de

Our compendium represents a compilation of all products from our range of services. These are subject to different delivery classes. Special variants included are often manufactured to customer specifications and sometimes require longer delivery times and minimum purchase quantities. Further advise can be given by your contact person.

■ SYSTEM TECHNOLOGY FOR THE DOOR

